

This pricing information is applicable for our *Fire Safety Maintenance* service.

## NEW FIRE EXTINGUISHERS

**ABC Dry Chemical Extinguishers:** These extinguishers provide protection from fires comprised of combustible materials, flammable liquids and electrically charged equipment. This type of extinguisher is appropriate for installation throughout the common areas of a condo building, including hallways, elevator rooms, basements and parking garages.

Item	Brand / Details	Price
<b>5lb ABC Dry Chemical</b>	Ansul and Amerex.	\$64.00 Includes wall hook and annual certification.
<b>10lb ABC Dry Chemical</b>	Ansul and Amerex.	\$89.00 Includes wall hook and annual certification.
<b>Others</b>	We can order and install a full variety of extinguishers for specialty applications.	Ask for Price
<b>Extinguisher Location Sign</b>	Location signs are installed near extinguisher to clearly identify location of unit. OSHA required. Vinyl, adhesive-backed	\$10.00 (no installation fee)
<b>Installation</b>	All sizes	\$10.00 (no fee if security cabinets are used)



## RE-CERTIFIED FIRE EXTINGUISHERS

We carry a full inventory of recertified extinguishers. Each of these reconditioned extinguishers has been fully "torn down" and rebuilt by our team to their original operating condition. All internal components have been inspected and replaced as needed. All extinguisher shells have been hydro-tested and are up-to-code, meeting all city and state certification requirements. Fully tagged and annually certified prior to installation. Save 40% over new extinguishers.



Item	Brand / Details	Price
<b>5lb ABC Dry Chemical</b>	Ansul, Amerex, Badger	\$42.00 Includes wall hook and annual certification.
<b>10lb ABC Dry Chemical</b>	Ansul, Amerex, Badger	\$59.00 Includes wall hook and annual certification.
<b>Extinguisher Location Sign</b>	Location signs are installed near extinguisher to clearly identify location of unit. OSHA required. Vinyl, adhesive-backed	\$10.00 (no installation fee)
<b>Installation</b>	All sizes	\$10.00 (no fee if security cabinets are used)

## FIRE EXTINGUISHER MAINTENANCE

City and State law requires that extinguishers receive maintenance by a licensed technician on an annual basis. See our website for complete details of the maintenance required in Illinois.

Extinguisher Type	10-Point Maintenance & Annual Certification
<b>5lb ABC Dry Chemical</b>	\$8.00*
<b>10lb ABC Dry Chemical</b>	\$8.00*
<b>20lb ABC Dry Chemical</b>	\$8.00*

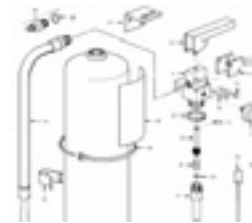

Any parts needed during maintenance will be charged at the rates listed below. There are no additional labor fees.

Part	Price
<b>Pull Pin</b>	\$1.00
<b>Hose Band &amp; Clip</b>	\$5.00

Pricing subject to change.

## FIRE EXTINGUISHERS SECURITY CABINETS

Cabinets provide a clean, modern look and act as a deterrent against theft of your extinguishers. We can source a full variety of cabinets to meet your specific needs. The most common security cabinets used by Associations are listed below. There are no installation fees on any extinguisher installed in a security cabinet.

### METAL CABINETS

Metal cabinets provide a clean, "high end" appearance that is a vast improvement over the look of an extinguisher attached directly to the wall. A cylinder lock and key protects the extinguisher and glass from tampering and theft. Each unit comes with an attached breaker bar used to break the glass in the case of a fire.

Item	Brand	Description	Price
<b>"Rome Metal S-19" Model Extinguisher Cabinet (For 5lb extinguishers)</b>	ROME	Sturdy metal cabinet with hinged door and glass panel. (White) Includes breaker bar as shown in photo. Additional details can be found here: <a href="http://www.romemm.com/products/">http://www.romemm.com/products/</a>	\$59.00
<b>"Rome Metal M-24" Model Extinguisher Cabinet (For 10lb extinguishers)</b>	ROME	Sturdy metal cabinet with hinged door and glass panel. (White) Includes breaker bar as shown in photo. Additional details can be found here: <a href="http://www.romemm.com/products/">http://www.romemm.com/products/</a>	\$69.00



### POLYSTYRENE CABINETS

These cabinets are made from thick, molded plastic which provides a rust-proof, dent-proof and easy to clean surface. Each comes with an attached hammer used to break the protective "break panel" in the case of a fire. There is no glass to shatter, which minimizes potential safety issues. Access restricted by a cylinder lock and key.

Item	Brand	Description	Price
<b>"Chief Fire 105-5" Model Extinguisher Cabinet (For 5lb extinguishers)</b>	CATO	Made of polystyrene, which is a thick plastic. Color = White. Includes breaker hammer. Full details can be found here: <a href="http://www.cato2007.com/downloads/CutSheet8-Chief.pdf">http://www.cato2007.com/downloads/CutSheet8-Chief.pdf</a>	\$39.00
<b>"Chief Fire 105-10" Model Extinguisher Cabinet (For 10lb extinguishers)</b>	CATO	Made of polystyrene, which is a thick plastic. Color = White. Includes breaker hammer. Full details can be found here: <a href="http://www.cato2007.com/downloads/CutSheet8-Chief.pdf">http://www.cato2007.com/downloads/CutSheet8-Chief.pdf</a>	\$49.00



### CABINET INSTALLATION & REPLACEMENT PARTS

Item	Price
Surface Mount Installation	\$15.00
Replacement Glass (ROME)	\$13.00
Replacement Break Panel (CATO)	\$15.00

Item	Price
Replacement Breaker Bar (ROME)	\$6.00
Replacement Hammer (CATO)	\$9.00
Replacement Lock Assembly (ROME/CATO)	\$8.00

### EMERGENCY LIGHTS & EXIT SIGN MAINTENANCE

Systems utilizing a battery backup must have a 90-minute load test performed on an annual basis. Our technicians will test the entire system and replace any dead bulbs and failing batteries. (Only batteries and bulbs that are faulty will be replaced) Upon completion of the maintenance, a label will be adhered to the side of the component recording the successful completion of the annual test.

**Annual Maintenance & Testing of Unit: \$15.00**

Any parts needed during maintenance will be charged at the rates listed below. If an exit / stair sign or emergency light unit is faulty and needs to be replaced, the service will be performed at the rates listed below.

Item	Description	Price	Image
<b>Annual Maintenance - AC Only Units</b>	Some Exit/Stair signs do not utilize a battery backup system. The technician will remove the glass, test and replace any failed bulbs, check the wiring and clean the unit. A label will be adhered to the side of the component recording the successful maintenance.	\$5.00	
<b>Chicago Approved Emergency Light</b>	Dual voltage 120/277 VAC, a push-to-test switch, a rechargeable sealed lead calcium battery, and 20 ga steel housing. UL listed and meets UL924, NFPA 101 Life Safety Code as well as City of Chicago requirements.	\$125.00	

Pricing subject to change.

## EMERGENCY LIGHTS & EXIT SIGN MAINTENANCE (CONT.)

Item	Description	Price	Image
<b>Chicago Approved Emergency Light (Remote Head Capable)</b>	Chicago approved steel emergency lighting; 6V 50W remote capable emergency light with two, 6V 12W adjustable bi-pin halogen lamp heads and 6V rechargeable battery backup. (Does not include remote head lamp.)	\$185.00	
<b>Chicago Approved Exit/Stairs Signs</b>	Dual voltage 120/277 units with a push-to-test switch. Other features include a rechargeable ni-cad battery backup, 20 ga steel housing, and canopy mounting kit. UL listed and meets UL924, NFPA 101 Life Safety Code as well as City of Chicago requirements.	\$185.00	
<b>Chicago Approved Combo Units</b>	Dual voltage 120/277 VAC with energy-saving LEDs and a push-to-test switch. Other features include a rechargeable ni-cad battery backup and 20 ga steel housing. UL listed and meets UL924, NFPA 101 Life Safety Code as well as City of Chicago requirements.	\$265.00	
<b>Replacement Glass for Exit/Stairs Signs</b>	Right Arrow, Left Arrow, No Arrow, Double Arrow. Replacement glass is not available for many older units. If replacement glass is not available, the unit must be replaced.	\$25.00	
<b>Replacement Glass for Emergency Light</b>	Glass cover for emergency light head. Includes metal C-Ring clip to hold glass in place.	\$12.00	
<b>Installation of Replacement Unit</b>	Replacement of an existing unit. Assumes all electrical wiring to unit is functioning normally. Technician must have access to the electrical breaker box. Cost includes service trip.	\$100.00	

Replacement Battery Type	Price
Sealed Lead - 6 Volt, 10-12 AMP	\$45.00
Sealed Lead - 6 Volt, 7 AMP	\$40.00
Sealed Lead - 6 Volt, 4-5 AMP	\$35.00
Ni-Cad - 4.8 Volt, 700mA/h	\$35.00
Ni-Cad - 4.8 Volt, 1200 mA/h	\$40.00
Ni-Cad - 1.2 Volt, 1200 mA/h	\$30.00

Replacement Battery Type	Price
Ni-Cad - 6 Volt, 700-1500 mA/h	\$40.00
Ni-Cad - 3.6 Volt, 700 mA/h	\$30.00
Replacement Lamps	Price
LED Retro Fit	\$42.00
Incandescent AC - 15W, 20W	\$5.00
Incandescent DC - 6V, 3.6W / 5.4W	\$5.00

Replacement Lamps	Price
Halogen - 6V 10Watt G4 Base (For emergency light units)	\$12.00
Sealed Beam Emergency - 6V 5-25Watt	\$25.00
Sealed Beam Emergency - 12V 12Watt	\$25.00
Sealed Beam Emergency - 12V 25Watt	\$29.00

## SMOKE & CARBON MONOXIDE DETECTORS

We provide a selection of battery-powered smoke and carbon monoxide detectors to provide an inexpensive solution to protect your residents.

Item	Description	Price
<b>Smoke Detector</b>	Battery Operated	\$25.00
<b>Smoke Detector (Wired)</b>	Wired w/ Battery Backup	\$35.00
<b>Carbon Monoxide Detector</b>	Battery Operated	\$35.00
<b>Carbon Monoxide Detector (Wired)</b>	Wired w/ Battery Backup	\$45.00
<b>Combo Unit (CO + Smoke)</b>	Battery Operated	\$45.00
<b>Combo Unit (CO + Smoke) Wired</b>	Wired w/ Battery Backup	\$55.00
<b>Installation</b>	N/A	\$10.00
<b>Installation above height of 12 feet</b>	Requires special ladders	\$25.00
<b>Annual Unit Servicing</b>	Includes cleaning, date check, testing and battery replacement	\$5.00
<b>Annual Unit Servicing - Over 12 feet</b>	Units above 12 feet in height require special ladders in order to access	\$15.00
<b>Battery</b>	AA / AAA	\$1.00
<b>Battery</b>	9V	\$3.00



Pricing subject to change.

## INTERIOR / EXTERIOR BULBS

The building's inventory of light bulbs can be changed on a proactive, annual basis. Please note that as a part of this optional service, all bulbs at the property are replaced regardless of status.

Item	Description	Price
<b>Bulb Replacement (Per fixture)</b>	Existing bulbs in a single fixture replaced with new items.	\$4
<b>Bulb Replacement (Per fixture) - Over 12 Feet</b>	Units above 12 feet in height require special ladders in order to access	\$10
<b>Standard (Type A) - Compact Fluorescent</b>	40 to 100 Watt equivalent	\$3
<b>Compact Fluorescent (Spiral) - Twist Lock</b>	GU24 Base	\$8
<b>Reflector Flood Lights- Incandescent / Halogen</b>	R/BR20, R/BR30, R/BR40	\$8
<b>PAR Flood Lights - Incandescent / Halogen</b>	PAR20, PAR30 short, PAR30 long, PAR38	\$10
<b>Fluorescent Plug-Ins</b>	2-pin, 4-pin / Twin tube, Quad tube / 7,9,13,18 Watt	\$10
<b>Sodium Hi Pressure</b>	70W, 100W, 150W, 200W, 250W	\$30
<b>Fluorescent Tubes (Bi-Pin)</b>	T8, T12 / 24", 36", 48"	\$8
<b>Fluorescent Tubes (Single-Pin T8)</b>	T8, Single pin	\$12
<b>Fluorescent Tubes (Single-Pin T12)</b>	T12, Single pin	\$10
<b>Fluorescent Tubes</b>	Circuline (Circular)	\$20
<b>Double End Halogens</b>	Short (3 inch), Long (4 5/8 inch) / 100,150,200,250 Watt	\$4
<b>Decorative Chandelier - Incandescent</b>	Flame tip, Torpedo tip / Clear, Frosted / E12 and E26 base	\$3
<b>Globes - Incandescent</b>	G8, G12, G14, G16, G18, G25	\$3
<b>Globes - Incandescent</b>	G30, G40	\$7
<b>Ceiling Fan - Incandescent</b>	40-60 Watt / E12 and E17 base	\$4

## NEEDS ANALYSIS EVALUATION

This is an optional service. The fee charged for our technician to visit the property and perform an analysis of your fire needs is \$100.00. The result of this visit is a Needs Analysis Report. [Learn more about the Needs Analysis Evaluation.](#)

## SERVICE FEE

A service fee, or trip charge, of \$75 applies for all service visits to the building.